

Schüco Window AWS 50

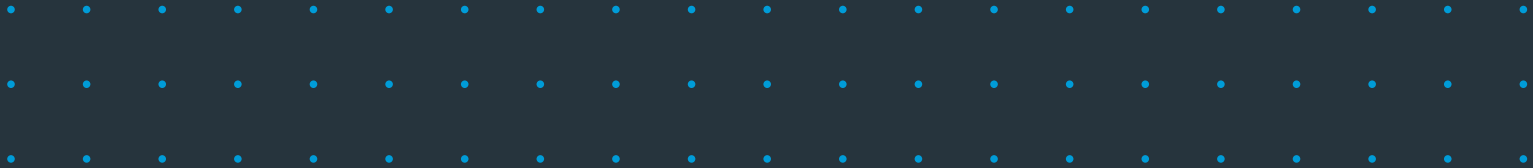

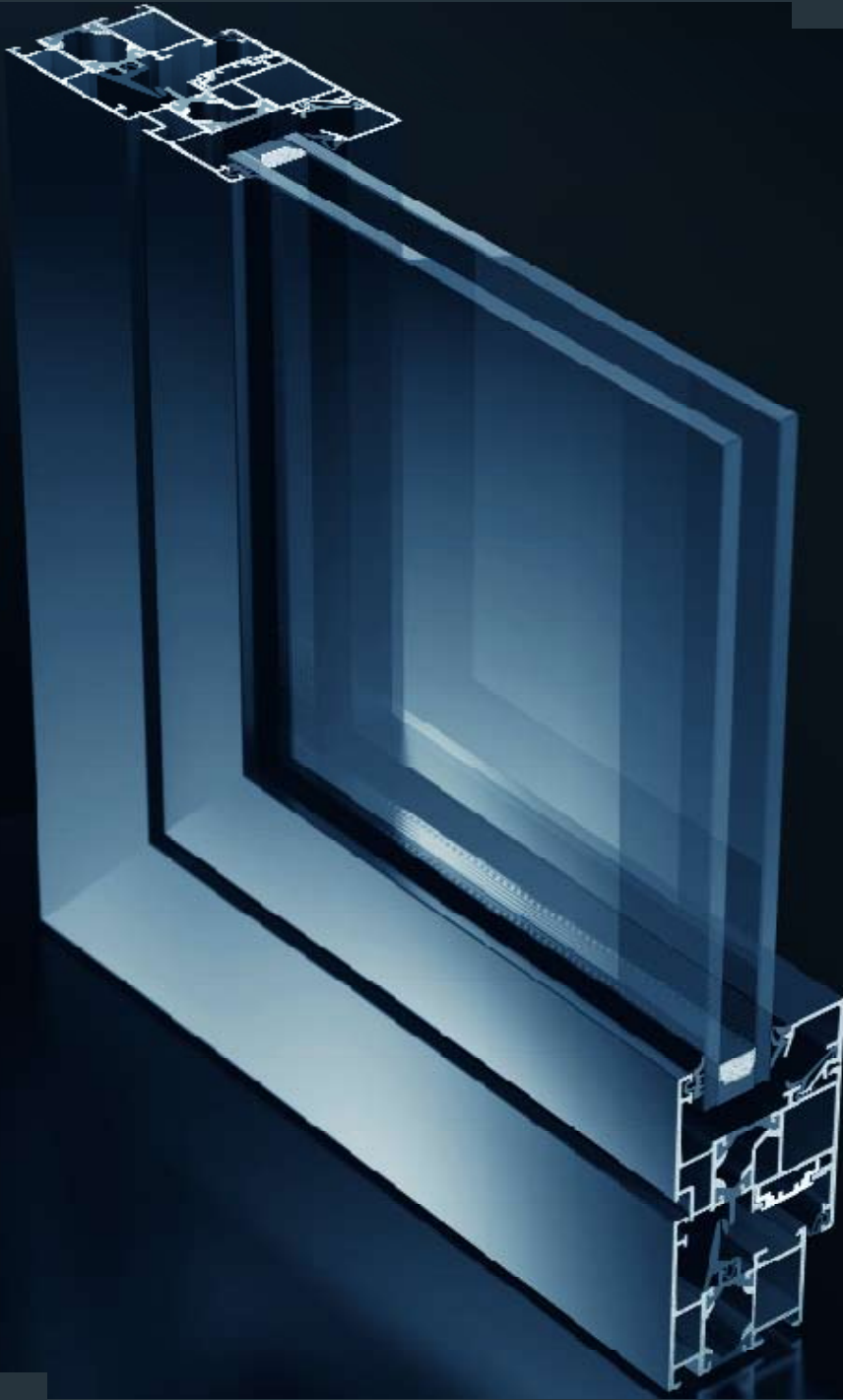

Schüco Window AWS 50 inward opening

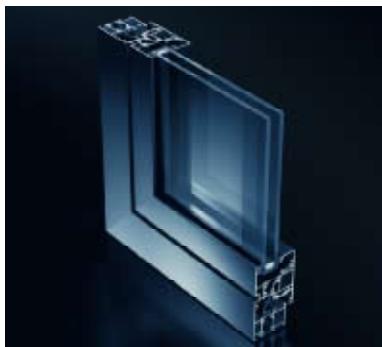

Schüco Window AWS 50

Schüco Window AWS 50

The Schüco AWS 50 window is the new series of window with thermal insulation and a basic depth of 50 mm. This series includes the Schüco AvanTec hidden fittings as standard. The Schüco AWS 50 window permits two-colour window construction. This series includes other designs, such as the Schüco AWS 50 RL window, intended for dwelling rehabilitation.

- Basic depth of 50 mm
- U_f values of $3.1 \text{ W/m}^2\text{K}$ (face width 117 mm)
- Available as outward-opening vent
- Crimped and nailed corner cleats
- Max. vent weight 130 kg
- Compatible with the Schüco ADS door range
- Wide profile range including the design systems Schüco AWS 50 RL (Residential Line) and Schüco AWS 50 SL (Soft Line)

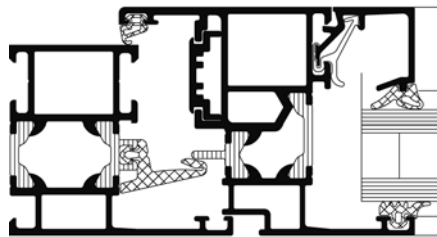

Schüco Window AWS 50
Scale 1:2

Technical data

Test	Standard	Value
Thermal insulation	EN ISO 10077-2	$U_f = 3,1 \text{ W/m}^2\text{K}$ 1)
Burglar resistance	DIN V ENV 1627	WK1
Watertightness	EN 12208	Class 9a
Air permeability	EN 12207	Class 4
Wind resistance	EN 12210	Class C5/B5

1)117 mm face width

Schüco International KG
www.schueco.com



Excellent Aluminium Systems
Sales Manager: Ole Ohm
Tel: 021 424 3070 · Fax: 021 424 3070 · Cell: 083 266 3120
Email: ole@excellentaluminium.co.za
Address: 43 Bellevue Road
Higgovale, Cape Town 8001